

FACTSHEET

CROWN BALLROOM



WEDDINGS





WELCOME TO THE CROWN BALLROOM

Crown Ballroom is Perth's newest and most prestigious event venue. Impeccable detailing covers every inch of the pillarless ballroom with its beautifully appointed chandeliers, custom designed carpets, elegant white wall panelling and high ceilings. Crown Ballroom features state-of-the-art audio visual technology and can be configured to suit any event or celebration. The adjoining open air terrace is the perfect pre-function area with views over the picturesque Perth landscape. The flexibility of this venue can accommodate between 100-1500 guests banquet style.

With the assistance of a dedicated Wedding Planner, our beautiful venues tailor to your wedding, down to every last detail. From our delectable menus prepared by world-class chefs, luxury hotel accommodation, premium dining and stylish bar experiences, Crown Perth is the perfect host for your memorable day.

FLOORPLAN

| ROOM | AREA (M ²) | HEIGHT (M) | THEATRE | CLASSROOM 2.5 PER TABLE | CABARET NO DANCE FLOOR (TABLE OF 8) | BANQUET NO DANCE FLOOR (TABLE OF 10) | DINNER, STAGE & DANCE FLOOR (TABLE OF 10) | COCKTAIL | U-SHAPE 2.5 PER TABLE | BOARDROOM |
|-------------------------------|------------------------|------------|---------|----------------------------|--|---|--|----------|--------------------------|-----------|
| CROWN BALLROOM | 2000 | 8 | 2400 | 1150 | 1216 | 1510 | 1410 | 2400 | - | - |
| CROWN BALLROOM 1 | 605 | 8 | 600 | 315 | 304 | 380 | 330 | 600 | - | - |
| CROWN BALLROOM 2 | 596 | 8 | 590 | 275 | 280 | 360 | 320 | 590 | - | - |
| CROWN BALLROOM 2, 3A, 3B & 3C | 1308 | 8 | 1440 | 711 | 736 | 920 | 880 | 1440 | - | - |
| CROWN BALLROOM 1 & 2 | 1208 | 8 | 1432 | 673 | 736 | 860 | 820 | 1432 | - | - |
| CROWN BALLROOM 3A, 3B & 3C | 706 | 8 | 600 | 300 | 304 | 360 | 330 | 600 | - | - |
| CROWN BALLROOM 3A & 3B | 472 | 8 | 400 | 175 | 208 | 230 | 200 | 400 | - | - |
| CROWN BALLROOM 3B & 3C | 480 | 8 | 400 | 175 | 208 | 230 | 200 | 400 | - | - |
| CROWN BALLROOM 3A | 223 | 8 | 156 | 74 | 88 | 90 | 80 | 200 | 42 | 40* |
| CROWN BALLROOM 3B | 245 | 8 | 176 | 95 | 88 | 90 | 80 | 200 | 45 | 40* |
| CROWN BALLROOM 3C | 231 | 8 | 156 | 74 | 88 | 90 | 80 | 200 | 42 | 40* |
| CROWN BALLROOM GREEN ROOM | 34 | - | - | - | - | - | - | - | - | - |
| BRIDAL SUITE | 25 | - | - | - | - | - | - | - | - | - |
| PCO SUITE | 52 | - | - | - | - | - | - | - | - | - |

^ Gap for stairs = U-Shape dance floor * No stage

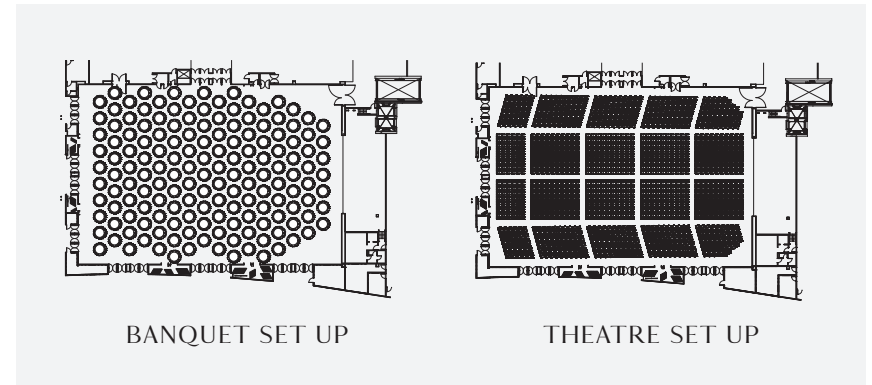
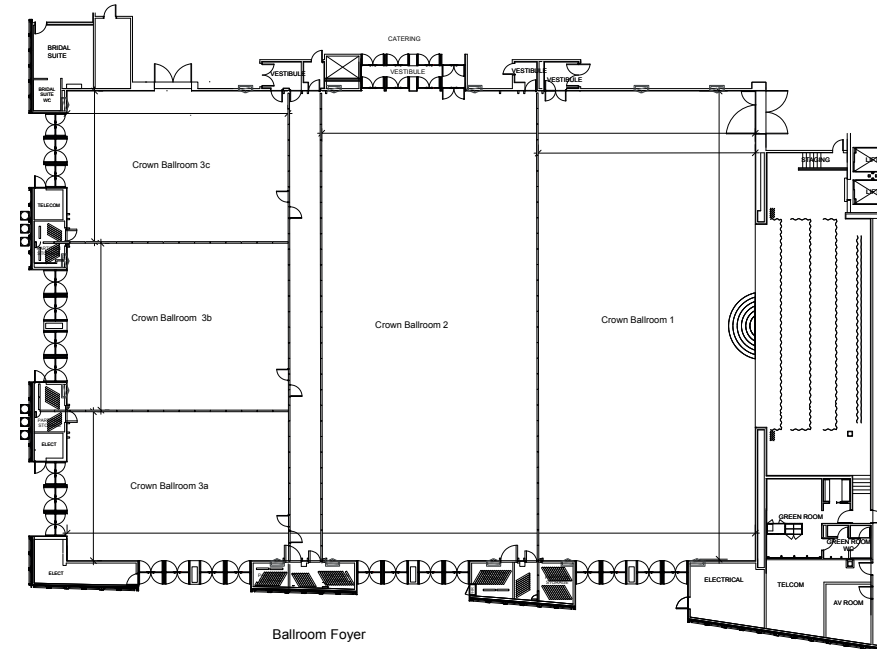



WEDDINGS

CONTACT US

+61 8 9362 7574 or
eventsales@crownpertth.com.au